

← iCoolsport.com

MiCool



New Features for 2013:

Weight: 19.8Kg (43.6 lbs) easily the lightest full function ice bath machine in the world.

Small Size: 30% smaller than it's big brother the iCool LITE

All New Water Circulation System: A new light weight linear water pump system is now integrated directly into a special water hose line. This adds both safety and convenience.

The new technology in line linear pump system allows you to use your MiCool not just with any iCool pool, but with optional low cost attachments, it allows you to use your MiCool with virtually any small pool, spa or bath tub.

The new pump is completely waterproof and can even be fully submerged in water if you need to pump up and over the side of a bathtub.

The new pump operates from very safe low voltage for total safety.

WARNING: Do not use with Chlorine, Bromide or Salt! Use regular non corrosive disinfectants only

OWNER'S MANUAL FOR iCOOL RECOVERY SYSTEMS



INTRODUCTION

Your MiCool is smallest system available that can provide the full range of ice bath therapy temperatures in any single person iCool pool or any normal sized bathtub. It's breakthrough technology packs the most cooling power possible in such a small space. The MiCool is designed for either fixed position operation or for easy transportation to almost anywhere you need to provide ice bath recovery.

To avoid damage it should always be transported in the purpose designed iCool military grade protective travel case, available as an option.

PERFORMANCE

Your MiCool has impressive performance for such a small system, but naturally it can not cool a pool as fast as our much larger iCools. You can expect cooling of at least 3 to 5 degrees C per hour and it may cool even faster depending your basic setup and local conditions. The temperature in the operating area, the amount of water being cooled and the starting temperature of the water will all have some effect.

FOR BEST PERFORMANCE

Operate in a well ventilated shaded area. Definitely not in direct sunlight.

Use an insulated pool (all iCool pools are properly insulated).

Use an insulating matt under the pool to prevent loss of cold into the ground. (All iCool pools have built in insulated mats but adding an extra mat can really help performance).

Use a pool cover. (All iCool pools come with a standard cover).

When water is very cold the difference between the pool water and the room temperature is very large, so the cold can be quickly lost. Good insulation reduces these losses. Good insulation will result in much faster cooling and save a lot of electricity.

HOLDING THE SET TEMPERATURE

In normal conditions, once your pool reaches your set temperature your MiCool has been designed to have enough cooling power to continue to hold that temperature even if several athletes are using the pool.

NEVER USE CORROSIVE CHEMICALS

Bromide and Chlorine can cause major long term damage even to the high grade stainless steel heat exchanger in your iCool and could eventually cause a total system failure that is not covered by your warranty. These chemicals eat away most metals and can also be harmful to athletes. This model iCool has a stainless steel heat exchanger tank that must only be used with fresh clean water. To control bacteria, a small amount of any common mild bathroom type disinfect is effective. Avoid the use of salt water to ensure long life of your system.

For extended use of the same pool water, iCool offers an optional small light weight filtration system that allows extended multi athlete use. It is fully compatible with your MiCool. Please see our website for advice.

POOL SETUP ADVICE

Before you turn on your iCool system you must set up and fill the pool. iCool portable inflatable pools come with their own instructions and are easy to set up. Please be sure that your pool is in the position you require before you fill it with water as the weight of the water will make it impossible to move it once filled.

IMPORTANT SAFETY ADVICE

Power supply voltage must be observed. Your MiCool can only be used with the voltage marked on the machine, it is not multi voltage. The voltage is marked under to the main power socket. It will be either 110volts (USA - Japan etc) or 220volts (Europe, SE Asia etc). **To ensure safe operation the power outlet you use must have a proper earth connection.**

BUILT IN SAFETY SYSTEMS

Your iCool system has many safety features to protect against such things as a loss of water flow, overheating of the system, or any chance of the user receiving an electrical shock. If any such potentially dangerous things should occur, in most cases your iCool will shut itself down and a red warning screen will appear to assist you to identify and correct the problem. In the case of overheating, the main fan will continue to run for some time until the temperature is safely back to normal. For the safety of users, any leakage of even a small amount of electrical current will cause the system to instantly remove all electrical power.

In the unlikely event that your system shuts itself down for any of these reasons, you must identify and correct the problem that has caused the safety systems to operate before allowing anyone to use the system.

TEST THE EARTH LEAKAGE SAFETY DEVICE REGULARLY

The main power switch is also part of the electrical safety circuit that can prevent the possibility of electric shock. It is essential to test this safety system each time you use the iCool to make certain it is operating correctly. This is very easy to do and takes only a few seconds.

Turn on the main switch (blue colour) and then press the orange test button marked T just above the switch. If the safety system is working normally, pressing the test button will cause the main power switch to shut off instantly. After a successful test, reset the main switch to ON to begin normal operation. **If pressing the test button fails to instantly shut off the power switch do not use the system until you contact iCool or an electrician for advice. Failures of this system are very rare.**

ADVICE ABOUT OBTAINING THE CORRECT FLOW OF WATER

Occasionally you may experience some difficulty getting the water to flow correctly through your iCool due to trapped air in the system or the hoses. Read these simple instructions to learn how to correct this.

THE PUMP: Water flow through your iCool is produced by a high quality long life circulating pump that, for the complete safety of the user, operates on a very safe low voltage and is outside of the iCool's cooling machinery.

Circulating type pumps can lift and move water reliably for many thousands of hours, however they do not provide suction and are therefore not self priming. Self priming type pumps are not as reliable over long periods and so are not suitable for this type of operation.

The pump with your iCool cannot begin to operate correctly unless it is fed with a head of water from a pool where the level is above the pump and any air trapped in the feeding hoses is removed. The water in the pool must be above the pump before you start it. There must be no air trapped in the supply hose from the pool to the pump and no part of the hose from the pool to the pump can be above the level of the water because this will trap air that can prevent water from flowing to the pump.

There are several easy ways to clear trapped air. For example, before you connect the outlet hose from the pump to the iCool, fill the pump with water and then connect it, that will remove all of the trapped air inside the pump. If this does not work immediately then you can touch the pump on off button 3 or 4 times so the pump is off for about 5 to 10 seconds each time. The surge when the pump starts can often clear the trapped air but it may take a few times if there is a lot of trapped air.

If you still do not have a good flow of water, with the pump running, undo the levers on the snap hose fitting that connects the hose from the pump to the bottom inlet on the iCool. There is no need to remove the fitting, just open the levers and this will allow any trapped air to escape. As soon as you see water coming out of fitting, quickly snap it back into position and lock it again.

You only need to bleed the system once for each set up. Once primed of air, the system will remain primed and water will normally flow instantly each time you start the pump until the pool is emptied or the iCool is moved.

Never operate the pump without water. Water pumps can not operate for long periods without water because the water provides the lubrication to the bearings. To prevent damage, your iCool system will shut down the pump automatically if water is not flowing properly for more than 2 minutes. If this happens a warning screen will normally appear to explain to you how to correct the problem.

QUICK START GUIDE

The following is a quick start guide to get your iCool up and running quickly, however you should read the entire manual to get the most out of your iCool.

STEP 1

Before you fill the pool you must connect the PUMP MODULE and the 2 hoses provided to the inlet and outlet fittings on the MiCool unit. iCool hoses have convenient snap fittings that are very quick and easy to use.

The large hose with the circulating pump in line connects from the bottom of the pool to the bottom inlet fitting on the MiCool

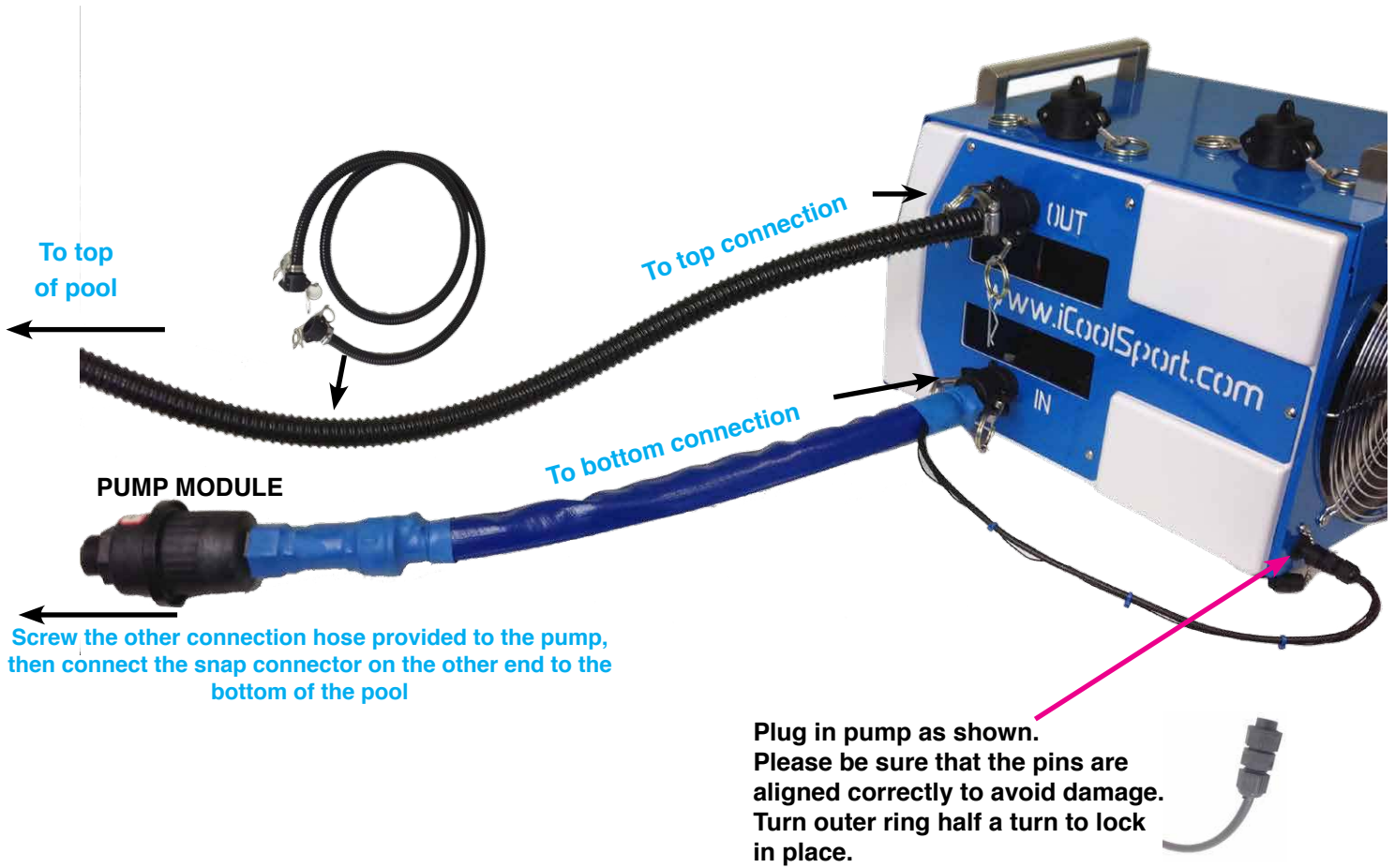

The iCool must be on the same level surface as the pool. It must not be above the pool. The pump must be on the floor and lower than the water in the pool. The water level in the pool must be well above the pump and the hose pipe with the pump must be flat on the floor to prevent air being trapped.

WATER FLOW WARNING

If water does not flow correctly after 2 minutes either during the initial set up or at any time during normal operation an alarm will sound.

The system will stop to protect the pump and a red warning screen will appear with instructions.

You must find the reason for the lack of water flow or the system will stop every 2 minutes for safety until the water flow is correct. The Water Flow Warning Screen also provides an option to over ride the flow protection system in the rare situation of a false alarm.

Never use this option unless you are absolutely certain that the system is stopping because of a false water flow alarm!

Once you use this function to disarm the flow safety monitor nothing will stop the system even if water is not flowing and this can seriously damage the pump as it will have no lubrication or cooling from the water.

This over ride function is only to be used for short periods where it is essential to keep your system operating until the reason for the false alarm can be determined and corrected. Water flow can also stop if the heat exchanger tank is frozen solid!

If you set the temperature below about 7°C or 45°F it is occasionally possible in certain climatic conditions for the heat exchange tank to freeze solid which will block the flow of water. The safety system monitors the heat exchanger tank and if no water is flowing the system will stop to protect the pump's bearings.

In order to cool the pool water to these extremely low temperatures the system cools to at least 5 to 7°C below the set temperature and this takes it very close to the temperature that water freezes solid.

Following international safety standards your iCool will not accept water temperature settings below 6°C or 42°F as this would put athletes using the system unattended at risk of hypothermia. However, the iCool is easily powerful enough to freeze the water inside the system itself and if this happens the safety screen above will appear and the system will stop.

Please be aware that the tank can only freeze if your setting is below 7 to 8°C and this can only happen in certain conditions. If your set temperature is above this then it is much more likely that the system has stopped because of a lack of water flow caused by either a hose or filter obstruction, or an air leak in the hoses, or trapped air in the system.

If the heat exchanger tank is frozen, then you must allow the system to warm up for about 15 minutes to thaw the ice. Leave the power switched on so that the fan can operate if necessary to thaw out the tank. Set a new temperature no lower than 8 or 9°C before restarting so that the tank does not freeze again.

STEP 3

Connect the power cable provided with your iCool to a standard power outlet capable of providing at least 10 amps in countries with a 220 V supply and 20 amps in countries with a 110 V supply. Although the system requires much less power than this in normal operation, all heat pump compressor motors need considerably more power for a few seconds each time they starts up.

For safety, the power outlet you use must be earthed correctly.

The main power switch is also part of the electrical safety circuit that prevents the possibility of electric shock. It is a good idea to test this system each time you use the iCool by turning on the main switch and then pressing the test button above the switch. If the safety system is working normally, pressing the test button will cause the main power switch to shut down instantly. After this test, reset the main switch to ON to begin normal operation.



STEP 4
TURN ON THE MAIN POWER SWITCH

Your system software will begin loading.

Your iCool has a full colour high-resolution touchscreen that eliminates all switches and provides complete control over your iCool system in a user-friendly and intuitive manner. It also provides a substantial amount of additional information to assist you. When you turn on the power for the first time the system will load the latest software from its memory card and run a diagnostic self test routine. This will take about 20 seconds. During this time you will see this screen (shown at right) and then a BLACK screen.



THE SOFTWARE LOADING SCREEN

The iCool logo will flash white.

The iCool logo is the system status bar, it changes colour or flashes to give a clear indication of each function.

While the software is loading it will flash white, the welcome screen shown above will appear and then a black screen appears for about 15 seconds while the computers test the safety systems.

When your personal logo screen (see examples below) appears it will stop flashing and show a steady white light to indicate that the systems check was successful and that your iCool is ready to use.



THE ICOOL STATUS LIGHT

If you did not request a personal logo screen then the standard iCool start screen will appear. A personal logo welcome screen similar to these samples will appear at this time.



Touch the logo screen anywhere to continue.

The **main operating screen** provides many options which are covered elsewhere in this manual, however to quickly start the system you can simply accept the default water temperature setting of 15°C or touch the **change settings** button to select a different temperature. 10°C will be inserted automatically but you can change to any temperature you require. **The temperatures can also be displayed in Fahrenheit. This is explained later in this Manual.**

Simply touch the up and down arrow buttons and the desired pool water temperature will appear on the bottom left-hand of the screen in the blue window marked “selected temperature”. The right-hand side of the screen shows the outside air temperature.

Once the pool water temperature you want your iCool to cool to is showing, touch the **start** button. This takes you back to the main run screen which is the screen that you will use most of the time during normal operation.



MAIN OPERATING SCREEN

STEP 5

Touch the **start pump** button. This will start the pump operating and water should begin circulating. The iCool Status Logo will turn **blue** to indicate that the water pump is on. **Note: When you touch start buttons they change to stop buttons and can then be used to stop that function if required.**

it is essential that the water is flowing correctly before you touch the start system button.

The water flow is pre set to an optimum flow of about 10-15 litres or around 2-4 gallons per minute. This allows time for the heat exchanger to operate at maximum cooling efficiency.

Pool water is completely changed approximately every 15 to 20 minutes.

Do not touch the **start system** button until you are sure that water is flowing smoothly. If water does not flow smoothly within a minute, please check that the hose from the bottom of the pool is flat on the floor and no part of it is higher than the top of the water. Check that the water in the pool is higher than the pump. If this does not correct the problem the system will sound an alarm and a red warning screen will appear with information about how to correct the water flow problem.



WATER TEMPERATURE SETTING SCREEN

STEP 6

Now that you have pre set your desired temperature and started the circulating pump, the touch screen should look like the picture at the top of this page. (of course the temperatures may be different). Notice that the pump button will have changed from **start** to **stop**. You can use this same button to start and stop the pump at any time.

Now, touch the **start system** button and the cooling cycle will begin. The iCool Status Logo will turn **green** to indicate that the water is being cooled to your preset temperature. When that temperature is reached the system will then cycle to maintain it at that temperature automatically.

The SYSTEM can only be started once within any 3 minute period to avoid overloading the compressor. If you don't hear it start do not touch the START SYSTEM again, it will start automatically after the 3 minutes safety period elapses.

If your iCool is the contrast model (cold and Hot) then, depending on the temperature you set, it will either heat or cool the water automatically to reach your preset temperature and then maintain it at that temperature. More detailed information about the operation of the contrast version can be found later in this manual.

for the safety of users, you can not set temperatures below 5°C or above 45°C. (40°F-112°F) in an emergency you can stop all functions immediately by touching the “all stop” button however, if the cabinet is hot, the fan may continue to run until the cabinet has cooled.

IF THE ICool STATUS LIGHT TURNS RED WHEN YOU START THE COOLING CYCLE:

The can only occur if the water temperature in the pool is already be lower than the cooling temperature you set. In this case the iCool will automatically attempt to heat the water to match the temperature you have set. The red iCOOL lights to indicate activation of the heating mode. You can not set the MiCool to cool water that is already colder than your setting.

No heating can occur if your model does not have the heating option.



MAIN OPERATION SCREEN

DETAILS OF THE MAIN OPERATING SCREEN

The pool temperature window shows the actual water temperature returning from the pool. This will vary slightly to the actual temperature in the pool because for safety reasons the electronic sensor is in the cooling unit not in the pool. It accurately reads the actual temperature of the water that is returning to the pool. The actual pool temperature will be slightly different depending on your particular setup. The temperature is always accurately maintained but if you want to display the actual pool temperature within 1 degree you can simply set an offset amount to compensate for the difference when selecting your required temperature.

The heat pump temperature window shows the temperature inside the cabinet. If this exceeds 70°C or 158°F the system will shut down, an alarm will sound and a warning screen will appear. This could happen in extremely hot conditions or if the unit is covered by an object such as a towel or anything that prevents proper airflow.

The outside temperature window shows the current room or outside temperature. It is not desirable to operate this system in temperatures above 42°C or 108° F. If the reading exceeds this you need to move the system to a cooler area or improve the air flow. The preset temperature window always shows your selected temperature. This is the temperature the water will be automatically cooled (or heated) to and maintained at.

CHANGING THE TEMPERATURE SETTING

You can change your preset temperature at any time by touching the change setting button, this will take you to the change settings screen. From here you proceed as described previously. If you have the contrast model, for safety reasons you cannot change directly from heating to cooling or cooling to heating. To do this you must switch off the entire system at the main switch and start again. This is required to reset the computer.

FAN SPEEDS

During normal operation the main fan will automatically change speeds as required to maintain the highest efficiency. The fan will be at full speed when temperatures are high or the water is warm.

You can display the pool temperature at full-screen size.

If you touch the number in the pool temperature window on the Main Operation Screen for a few seconds the screen will change to a full-screen display of that temperature.

This is useful if you wish to monitor the system from a distance. The pre-set temperature and the outside temperature continued to display in smaller windows for your reference. To return to the main operating screen touch the [back 1](#) button.

To stop the system at the end of your recovery session there are several ways to stop the system and close it down. You can stop the cooling system by touching the [stop system](#) button, in this case the pump will continue to run, however you can stop to pump at any time by touching the [stop pump](#) button. Alternatively you can stop everything by touching the [all stop](#) button. Alternatively you can simply switch off the main power. If you use the [all stop](#) button the fan may continue to run for a short time to cool the cabinet.

EMPTYING THE POOL USING THE BUILT IN PUMP.

You can use the main circulating pump to empty the water from the pool by detaching the top hose from the top of the pool and directing it to a drain. The pump can be turned on and off at any time using the pumps [stop/start](#) button.



DETAILED OPERATION

THE TOUCH BUTTON FUNCTIONS

SYSTEM SETTINGS



When your iCool start up, the first screen you will see offers you a [system settings](#) button. **Optimum settings are automatically selected** so there usually no need to use this feature. The three settings you can change are the fan speed range, the temperature from degrees Centigrade to Fahrenheit and the sound level from the screen.

Main cooling fan speed. This allows you to set the main cooling fan to either [normal](#) or [quiet mode](#). **Generally you should always leave it in the NORMAL mode** which is fully automatic and allows the system to control the fan speed to give the very best efficiency and fastest cooling.

If you are in a very quiet environment you can select [quiet mode](#), but you must be aware that this will reduce the cooling ability of the system, however it will be quieter overall as the fan will not run higher than 60% of maximum **unless there is a risk of overheating, in which case the safety system will turn the fan back to high no matter what the setting**. The [normal](#) setting is used to give absolute maximum cooling power where higher fan noise is not a problem. on a normal day this gives about 25% more cooling than in the [quiet mode](#). If cooling seems lower than normal, check to see if this feature was previously set to Quiet Mode.

Temperature display scale: This can be set to either Centigrade or Fahrenheit and this changes all of the displays throughout the entire system. When you first start the iCool it will normally start in Centigrade as this is the world standard. **Due to complex decimal calculations between C° and F° there may be minor difference in the true F° displays.** This has no effect on actual cooling accuracy.

The [sound level](#) adjusts the sounds made by touching the screen and by the alarms. Normally it should be left on high to assist with settings and to make sure alarms are heard.

A red dot indicates which setting is selected in each of the available settings.



TEMPERATURE SETTINGS



When your iCool starts up, you are offered 3 different ways to choose a water temperature setting. Whichever method you choose it eventually takes you to the main run screen. If you make no setting, the system will automatically insert 15°C.(around 59°F) In this case you would navigate directly to the main run screen in order to access and start the pump and cooling system.



If you want to use your previous setting from the last session, you can touch the [use previous setting](#) button and the last setting you used will be automatically inserted into the system. Previous settings may have been lost if you have removed to mains power.



If you want to make a new setting, which is the most common choice users make, you touch the [make new settings](#) button and this will take you to the screen illustrated above, where you can use the up and down arrows to select the temperature you require. After you make your setting touch of the start button to go to the main screen where you can start both the pump and the cooling system and where all relevant temperature information is clearly displayed.



WATER TEMPERATURE SETTING SCREEN



WATER TEMPERATURE FULL SCREEN

TEMPERATURE LIMITATIONS



Because of the dangers of hypothermia in the case of an unattended athlete using the pool, your system will not allow you to set temperatures below 5°C/40°F. If the model you are using is the contrast model which also provides heating for contrast therapy you cannot set the temperature above 45°C/112°F because of the risk of scalding. These temperature limits have been set after wide consultation with the sporting industry around the world. There are no demonstrated benefits in using water temperature lower than 5°C or above 45°C and therefore the risk of doing so is not justified.

TIMING FUNCTIONS



Your iCool offers a number of very useful timing functions including a real-time clock, a countdown timer to time recovery and training sessions and a timer to shut down the system automatically at a predetermined time after use. To set up and use these functions touch the **TIMER FUNCTION** button on the home screen. You can reach this screen by using the **BACK 1** button or the **HOME** button.



TIME SETTING SCREEN

In order to use these functions you first need to set the time of day on the built-in clock.

To set the clock touch the [set main clock](#) button on the timing functions screen and the time setting display on the bottom right of the screen will begin flashing. You must set it while one of the numbers is flashing by using the up down and left right keys. Once you stop using these keys for more than a few seconds the display will stop flashing and the time showing is set into the system and the clock begins operating. **The iCool clock operates in the universal 24-hour time style.**

AUTOMATIC SYSTEM SHUTDOWN TIMER



You can preset your iCool to shut down at any time up to five hours in the future. This is very convenient for coaches and specialists who may want to leave the training area early but want to make sure that the system is not left running needlessly. To set this time, touch the [set shut down button](#) and the clock digits on the bottom right of the screen will begin to flash as with setting the clock. Use the same up down and left right arrows to set the number of hours and minutes you wish to elapse before the system automatically shuts down. The system automatically begins the countdown and will stop when the time you set reaches zero. The time remaining before shutdown is displayed on the main clock display screen.

As the same arrows are used to set all three time functions, to avoid confusion, a red dot appears next to the button of the function being set.

A very popular and useful feature of your iCool is the [session countdown timer](#).

This allows you to accurately control the immersion times of athletes and to repeat those times as often as needed. This is an essential part of successful cryo recovery therapy and is just as important as maintaining accurate and consistent temperatures, which of course your iCool does perfectly.

The session timer is set up from the main time setting screen by touching the [set countdown](#) button. The numbers on the setting screen in the bottom right-hand corner will begin to flash and you can use the left, right and up, down arrows to change the time in minutes and seconds. Once you have set the time you want your athletes to remain in the bath, touching the [display countdown full-screen](#) button will take you to the screen illustrated below. This screen allows you to see the countdown from a distance and also to control it in various convenient ways. The current pool temperature and the outside temperature will also be displayed.



The count down can be set for once only, or it can repeat automatically as many times as you like. This is particularly convenient if you have a number of athletes using the same pool at the same time. The system beeps for each of the last five seconds at the end of each countdown to warn the athletes to get ready to get either in or out of the pool and pauses for several seconds to allow the changeover before the countdown begins again (if it is set in the repeat mode).



Resets time to the preset value in the single shot mode, ready to start again by pressing the START button





You can pause the countdown at any time and start again from the same position with this button, or touch reset to start from the top.



When this button is pressed the countdown will repeat until the repeat function is cancelled by pressing once again. A red dot indicates that it is active



This button starts the countdown



You can also display the main clock, showing the time of day in full-screen mode if required by touching the display clock full screen button.

To go back to the previous screen touch the back 1 button.

EXTERNAL LIGHTING

This model does not have external lights.



STEREO SOUND SYSTEM

This model does not have a sound system.



THE HELP SYSTEM

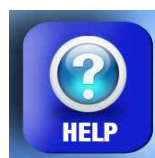

Your iCool has an extensive built-in electronic help system. Detailed and well illustrated helpful information on every important subject to do with the operation of your iCool, is available from almost any screen simply by touching the help button.

Touching any help button will take you to the screen illustrated on the right. The screen has eight menu buttons covering all of the important topics you are ever likely to need assistance with.

When you touch the menu button covering the topic you need assistance with, the screen will change to a series of pages covering that subject. Sample screens are illustrated below and opposite.



You can flip forward or backwards from page to page using the buttons on the right-hand side of the help screens or you can return to be main help menu page at any time.

The built-in illustrated help system is a revolutionary new idea and we are constantly updating it as new information and new feedback comes in from all over the world from iCool clients and from our recovery research programs in several countries.

Some help pages may not be installed on your iCool when it is delivered, so that your local dealer can install them to suit your country and sport. Alternatively iCool can provide a free update memory card with the latest help menus to suit your needs.

If your screen locks up or displays random text while using the help menus, please restart the iCool at the main switch to correct this.

EXAMPLES OF THE ELECTRONIC HELP SYSTEM'S PAGES

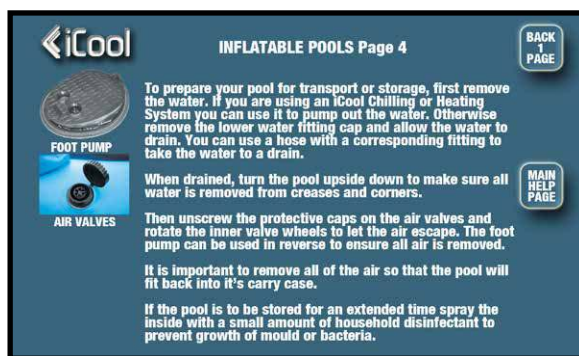
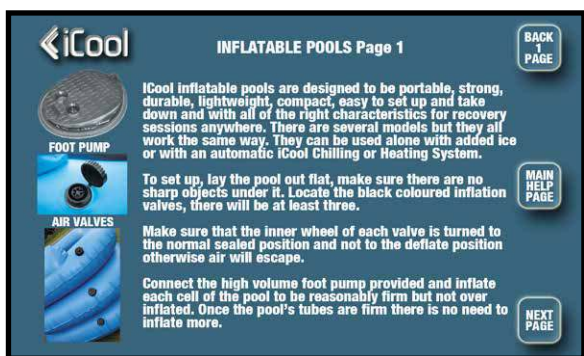
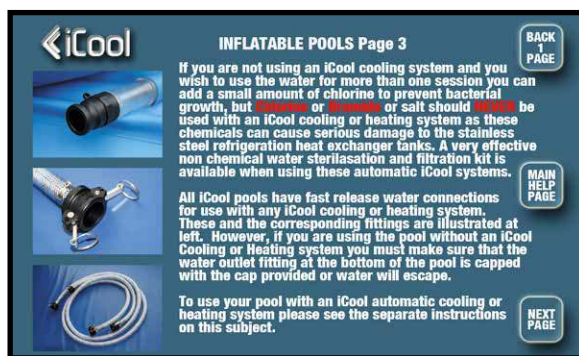
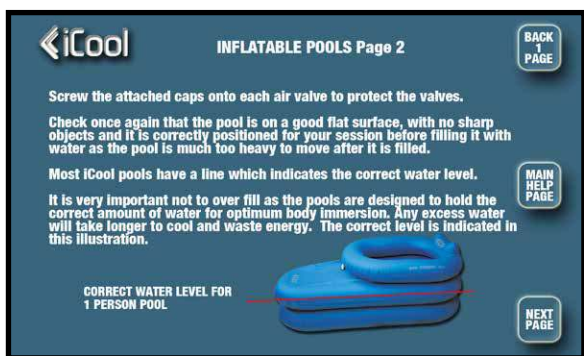

You may need a free local upgrade memory card to access all help files for your region.

LOCKING YOUR ICOOL SYSTEM TO PREVENT TAMPERING.



Your iCool has an electronic lock.

As you can see, iCool Systems have attractive user interfaces, this makes them easy and very intuitive to use, but the downside is that untrained people sometimes like to play with the colourful touchscreens. As with any sophisticated piece of equipment when people start pressing buttons at random anything can happen. Your

iCool has many safety features to prevent a person tampering with the system from causing a disaster, but most of these safety features involve Automatically shutting down the system which of course is undesirable. We have covered this by installing a secret locking routine. It is a good idea to keep this secret to as few people as possible.

To lock the screen so that no further inputs can be made, touch and hold the iCool icon on the main run screen for more than 10 seconds (you can only lock from this main screen). A picture of a lock will appear. While ever this lock is visible it is not possible to make any inputs or to change screens.

To unlock the system and returned to normal, repeat the procedure. Touch and hold the iCool icon for more than 10 seconds. The lock will disappear and all functions will return to normal.

IF YOUR SCREEN FREEZES OR FAILS TO RESPOND:

As with all computers and computer controlled devices it is possible that occasionally the system could freeze due to data or software conflicts. Your iCool has 2 computers that monitor and communicate with each other. Occasionally a data error can cause them to stop communicating.

We have designed the system to be as fail safe as possible. In most cases if the screen freezes the main computer will still carry on running the system and monitoring the safety features but you will not be able to change anything. You can either allow it to keep running if that is more convenient, or you can restore the system to normal operation by switching off the main power and re starting. Exactly as you would do if your computer or smart phone freezes.

[The system will always reset to normal when you restart it.](#)

When your screen first starts up and the welcome screen appears a small warning notice may appear in the centre of the screen for one or two seconds referring to the inter computer communication requirements, this is normal.

EMERGENCY OVERRIDE PROVISIONS

Certain safety features in your iCool can be overridden in the event of a partial failure. iCool systems are very reliable and have attained an excellent reputation around the world for this. In addition we have done all that we can in the designs to build-in ways to work around any partial failure, so that you are not prevented from using your system for an important event. There are some circumstances in which it would be acceptable to temporarily override certain safety systems that may become too sensitive and cause trouble until they can be properly readjusted. This allows systems to continue to operate in circumstances where otherwise it might not be possible. Of course we do not advise the overriding of electrical safety circuits.

For example, depending on the way your system has been set up, it sometimes occurs that the water flow monitoring system may be too sensitive and will stop the pump because it appears that water is not flowing properly. We allow this to be over ridden if it becomes troublesome. Instructions on how to do this will appear on the screen automatically if this happens. It must be remembered of course that if you disarm this system the pump is no longer protected from running dry and therefore without lubrication so it is essential that you manually monitor the water flow. Our staff can assist you by phone or e-mail to overcome most problems on the spot.

If you use this over ride function the pump could be damaged if no water flows for more than a few minutes.

[Even if the entire touchscreen user interface fails, we can usually still get you going.](#)

In our efforts to remain the world's number one supplier of mobile ice bath systems, we have continued to improve reliability, but we have also engineered ways to ensure that no matter what happens in the field, in most cases you can still use your iCool for that important event.

Realistically, even the best electronic systems occasionally have problems, especially in portable systems that have a relatively hard life.

Fortunately, we have very few such problems, but as an added benefit we have built into all iCool's a complete manual override system that allows your iCool to operate effectively even if all of the main electronics fail for whatever reason.

We do not publish this over ride information in the manual because it is a little different from model to model, but in the rare event that you ever have a failure of the electronics which prevents you from operating your iCool, just call or e-mail us for advice. You will be contacted promptly and we will explain how to work around your problem until we can arrange repairs. This is an important service that we hope you never need, but it's good to know it is there.

In addition to this service you will be pleased to know that your iCool is of a modern modular design, which means that most components can be easily replaced in the field and often by the owner.

IF THE STATUS BAR LIGHT ON THE ICOOL TURNS RED WHEN YOU START THE COOLING CYCLE.

If the water temperature in the pool is already lower than the cooling temperature you set then the iCool will automatically attempt to heat the water to match the temperature you have set. The red bar indicates activation of the heating mode.

No Heating can occur if your model does not have the heating option.

For safety reasons the system will not change from heating mode back to cooling mode unless you re start it by turning the main power off and back on. For cooling, you must set a temperature that is lower than the present temperature of the water. If you need to set a temperature that is very close to or the same as the present pool temperature try starting the cooling within a few seconds after starting the pump, before the system has time to read the water temperature.

SPECIFICATIONS

	MiCool
COOLING POWER	2100 Watts
HEATING POWER	N.A
RUN (& Max.) POWER @220Volts	4 Amps (7 Amps)
RUN (& Max.) POWER @110Volts	8 Amps (15 Amp)
HEAT PUMP TYPE	Rotary
EARTH LEAK SAFETY DEVICE	30 Milliamps
HEAT EXCHANGER TANK	Stainless steel
ROLLER BEARING WHEELS	No
STAINLESS HANDLES	Yes
AREA LIGHTING	No
COLOUR TOUCH SCREEN	Yes 800 x 480 Hi Res
ISOLATED WATER PUMP	Yes
WATER PUMP CAPACITY	25 litres per minute
WEIGHT KG / POUNDS	19.8 (43.6)
DIMENSIONS (cm) H x W x D	29 x 32 x 45
DIMENSIONS (inch) H x W x D	11.5 x 12.5 x 17.7
COUNTRY OF ORIGIN	Australia
Refrigerant	HR22 Green Gas

NOTE ABOUT SPECIFICATIONS:

iCool Systems are sold all around the world and these specifications may be different for units delivered in your country due to local conditions or regulations or other factors. Also certain specifications may change due to ongoing research and development, because we are constantly improving our products. We welcome your feedback and suggestions and we offer support for general enquiries and information for specific countries on our website at.



Thank you for choosing iCool the world's most popular ice bath therapy and recovery systems.